

■ Frequently asked questions

What do I do once I inject my dose?

Replace the outer needle cap and unscrew the capped needle.
Replace the pen cap.

How do I store my pen?

HumaPen® SAVVIO™ should not be stored in the refrigerator. Refer to the Lilly 3 mL insulin cartridge consumer information leaflet (package insert) for complete insulin storage instructions.

What if I can't attach the cartridge holder to the pen body?

Check that the insulin cartridge is fully inserted into the cartridge holder. Line up the holder with the pen body and twist until secure.

What if I see air bubbles in the cartridge?

You may still see a small air bubble in the cartridge after priming. If you have properly primed the pen, this small bubble will not affect your insulin dose.

What should I do if my full dose cannot be dialed?

If the dose is greater than the number of units left in the cartridge, you may either inject the amount remaining in your current cartridge and then use a new cartridge to complete your dose, OR inject the full dose with a new cartridge.

What if it is difficult to push the injection button when I try to inject?

Your needle may be clogged. Try attaching a new needle and then priming the pen. Pushing the injection button down quickly may make the button harder to push. Try pushing the button more slowly.

Using a larger-diameter needle will make it easier to push the injection button. Ask your healthcare provider which needle is best for you.

HumaPen® savvio™

* For additional information or more detailed instructions, please review the User Manual or Quick Guide enclosed in the HumaPen® SAVVIO™ packaging.

If you have any questions about or problems with your HumaPen® SAVVIO™ or require assistance, contact your healthcare provider or the Lilly Customer Response Centre at 1-866-545-5972 or write to:

Eli Lilly Canada Inc.
3650 Danforth Avenue,
Toronto, ON M1N 2E8.

■ Key steps* to using the HumaPen® SAVVIO™

HumaPen® savvio™



HumaPen® SAVVIO™ is designed to be:

- Easy to use
- Accurate and durable
- Available in a choice of colours



HumaPen® is a registered trademark of Eli Lilly and Company, used under license.
SAVVIO™ is a trademark of Eli Lilly and Company; used under license.

© 2013, Eli Lilly and Company. All rights reserved.

CADV00025

Lilly

Lilly

■ Getting to know your HumaPen® SAVVIO™

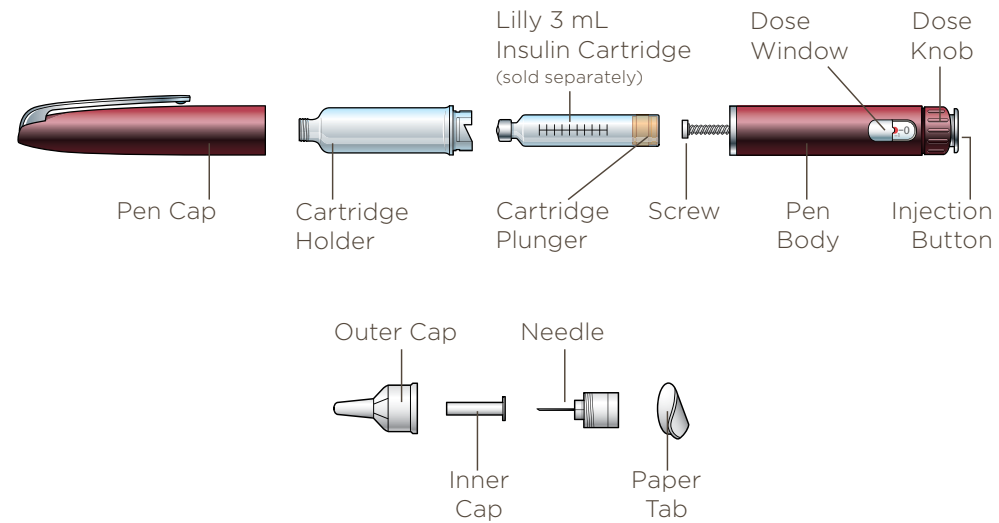

■ 1. Inserting a 3 mL cartridge

Inspect the insulin cartridge before you insert it.

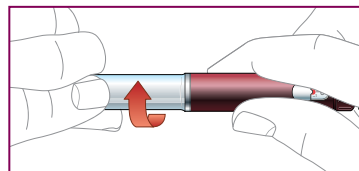

Twist the cartridge holder to detach it.

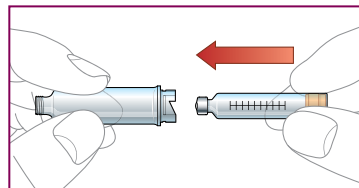

Insert the small end of the cartridge.

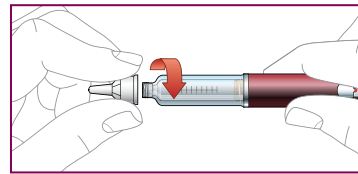

Push the cartridge holder straight into the pen body.

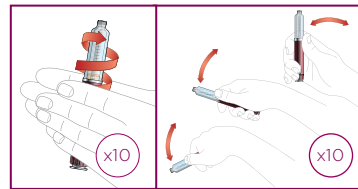

Twist the cartridge holder onto the pen body until you feel a click.

For cloudy insulin only: Gently roll the pen 10 times and turn it upside down 10 times to mix the insulin.

■ 2. Attaching the needle

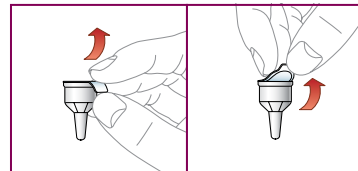

Remove the paper tab and attach the needle.

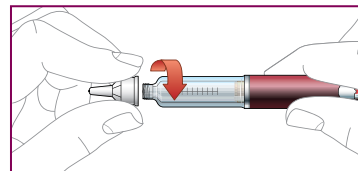

Screw the needle straight onto the cartridge holder until secure.

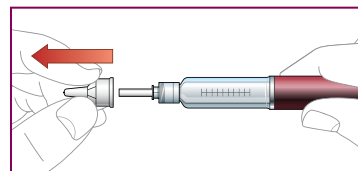

Pull off the outer cap and keep it.

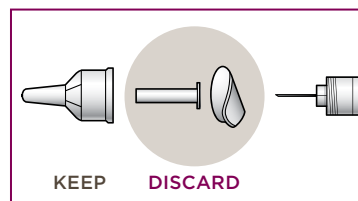

Pull off the inner cap and discard it.

■ 3. Priming your pen

Prime the pen before every use to help remove air in the needle or cartridge. If the pen is not primed, you may get too much or too little insulin.

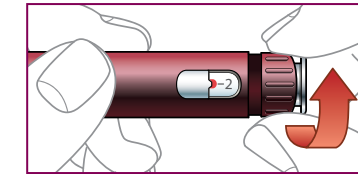

Dial 2 units.

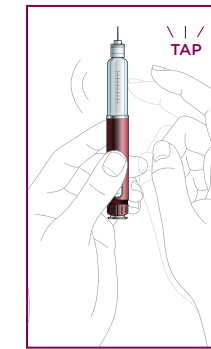

Tap the cartridge holder to move any air to the top.

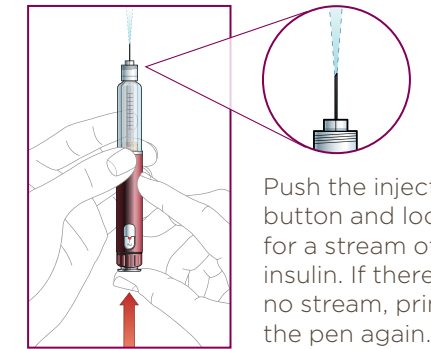

Push the injection button and look for a stream of insulin. If there is no stream, prime the pen again.

■ 4. Injecting your dose

Dial your dose. If you dial too many units, you can dial backward to correct the dose.

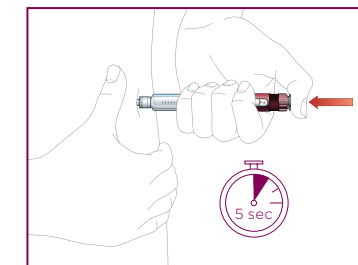

Insert the needle.

Place your thumb on the injection button and push firmly until the button stops moving.

Hold the button in for 5 seconds.

Remove the needle from your skin.

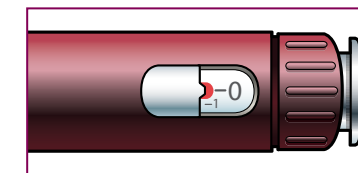

Check for a 0 in the dose window to confirm you injected the full dose.